

► **Code Number**

3780057

► **Description**

Exposed, AC-powered, sensor-activated, high-efficiency water closet flushometer with a single-flush side mount unit for top spud floor mounted or wall hung bowls.

► **Flush Cycle**

Sloan 111-1.28 SF5M HW High-Efficiency (1.28 gpf/4.8 Lpf)

► **Specifications**

Quiet, Exposed, Diaphragm Type, Chrome Plated Closet Flushometer with the following features:

- PERMEX® synthetic rubber diaphragm with linear filtered bypass and Vortex Cleansing Action™
- ADA Compliant AC-powered infrared side mount sensor for automatic "No Hands" operation
- Chrome Plated Infrared Sensor Housing
- Can be Mounted on either the Left or Right Side of Valve
- True Mechanical Override Flush Button
- "User in View" Flashing LED
- 72-Hour Sentinel Flush
- Infrared Sensor Range Adjustment Screw and Reset Button
- 1" I.P.S. Screwdriver Bak-Chek® Angle Stop with Vandal Resistant Stop Cap
- Trap Primer
- Spud Coupling and Flange for 1 1/2" Top Spud
- Spud Coupling and Flange for 1-1/2" Top Spud
- Sweat Solder Adapter w/Cover Tube and Cast Wall Flange with Set Screw
- No External Volume Adjustment to Ensure Water Conservation
- Handle Packing, Main Seat, Stop Seat and Vacuum Breaker Molded from PERMEX® Rubber Compound for Chloramine resistance

Valve Body, Tailpiece and Control Stop shall be in conformance with ASTM Alloy Classification for Semi-Red Brass. Valve shall be in compliance with the applicable sections of ASSE 1037, ASME 112.18, ASME 112.19, ANSI 117.1. Installation conforms to ADA requirements.

► **Accessories (specify separately)**

- 120 VAC Input/6 VAC Output, 50/60 Hz (3 VA) Plug-In (will operate 1 unit)
- 120 VAC Input/6 VAC Output, 50/60 Hz (25 VA) Box Mount (will operate up to 6 units)

► **Fixtures**

Consult factory for matching Sloan brand fixture options.



Side Mount units do NOT include the flushometer

► **Smart Sense Technology™**

Sloan's SF5M flushometers are equipped with Smart Sense Technology™, which applies extended range and logic techniques to significantly reduce water usage in high-use urinal applications; such as when a continuous line of people (queue) forms. In fact, during a continuous queue, the urinal will only flush after every fifth user.

► **Automatic Operation**

Sloan's SF5M flushometers are activated via multi-lobular infrared sensor. The sensor sets the flushing mechanism when the user is detected and Completes the flush when the user steps away.

► **Manual Operation**

Sloan's SF5M flushometers can also be activated manually by pushing the black TMO button.

► **Hygienic**

Touchless, sensor activation eliminates the need for user contact except to initiate the True Mechanical Override button when required, to help control the spread of infectious diseases. The 72-Hour Sentinel Flush keeps fixture fresh during periods of non-use.

► **Compliance & Certifications**



This space for Architect/Engineer Approval

### ► ELECTRICAL SPECIFICATIONS

#### Control Circuit

Solid State

72 Hour Sentinel Flush

6 VAC/7.6 VDC Input

Closest Range: 2-3 Seconds Arming Delay

#### Sensor Type

Infrared Convergence Type Object Lock Detection

#### Sensor Range

Factory Set at 22" - 42" (559 mm-1067 mm)

If converted to urinal range setting: 15-30" (380-762 mm)

#### Transformers

Sloan Part # EL-386 (Plug-In) 120 VAC Input/6 VAC Output, 50/60 Hz (3 VA)

Sloan Part # EL-451 (Box Mount) 120 VAC Input/6 VAC Output, 50/60 Hz (25 VA)

#### Indicator Lights

User in View

#### Valve Operating Pressure (Flowing)

25-80 psi (172-552 kPa)

### ► ROUGH-IN

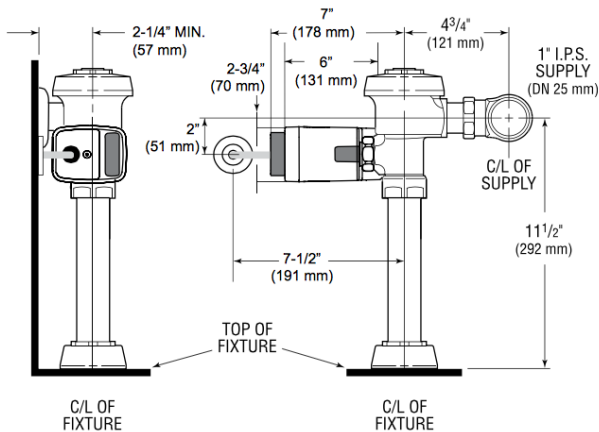

EL-700-A Single-Flush Side Mount Hardwired unit shown on a Sloan 111 closet flushometer

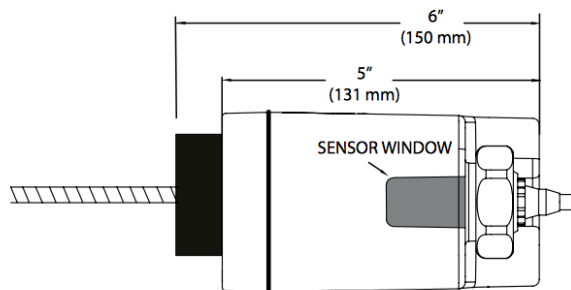

Side Mount Hardwired Unit Dimensions

### ► OPERATION

1. A continuous, invisible light beam is emitted from the object infrared sensor.

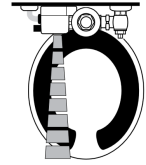

2. As the user enters the beams effective range, 22-42" (559-1067 mm), the object lock infrared sensor senses the user.

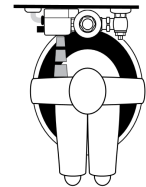

3. When the user steps away from the object lock infrared sensor, the circuit initiates the flushing cycle to flush the fixture. The circuit then automatically resets and is ready for the next user.

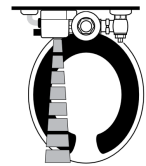

### ► SIDE MOUNT COMPONENTS

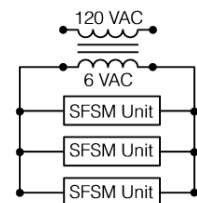
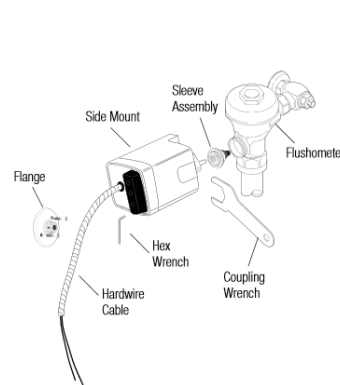

One EL-386 transformer serves one (1) SF5M closet/urinal flushometer. One EL-451 transformer serves up to six (6) SF5M closet/urinal flushometers. Specify part number and number of transformers required accordingly.