



a Geberit company

FOR TECHNICAL ASSISTANCE
 1-800-TEC-TRUE (1-800-832-8783)

2100 South Clearwater Drive
 Des Plaines, IL 60018
 Phone: 847-803-5000
 Fax: 847-803-5454
 www.chicagofaucets.com

REPAIR PARTS

BY: SID DATE: 11-17-11

CHK: *[Signature]* REV: 09-25-14

FITTING NO.

349-E35ABCP

SUBMITTED MODEL NO.

ITEM NO.

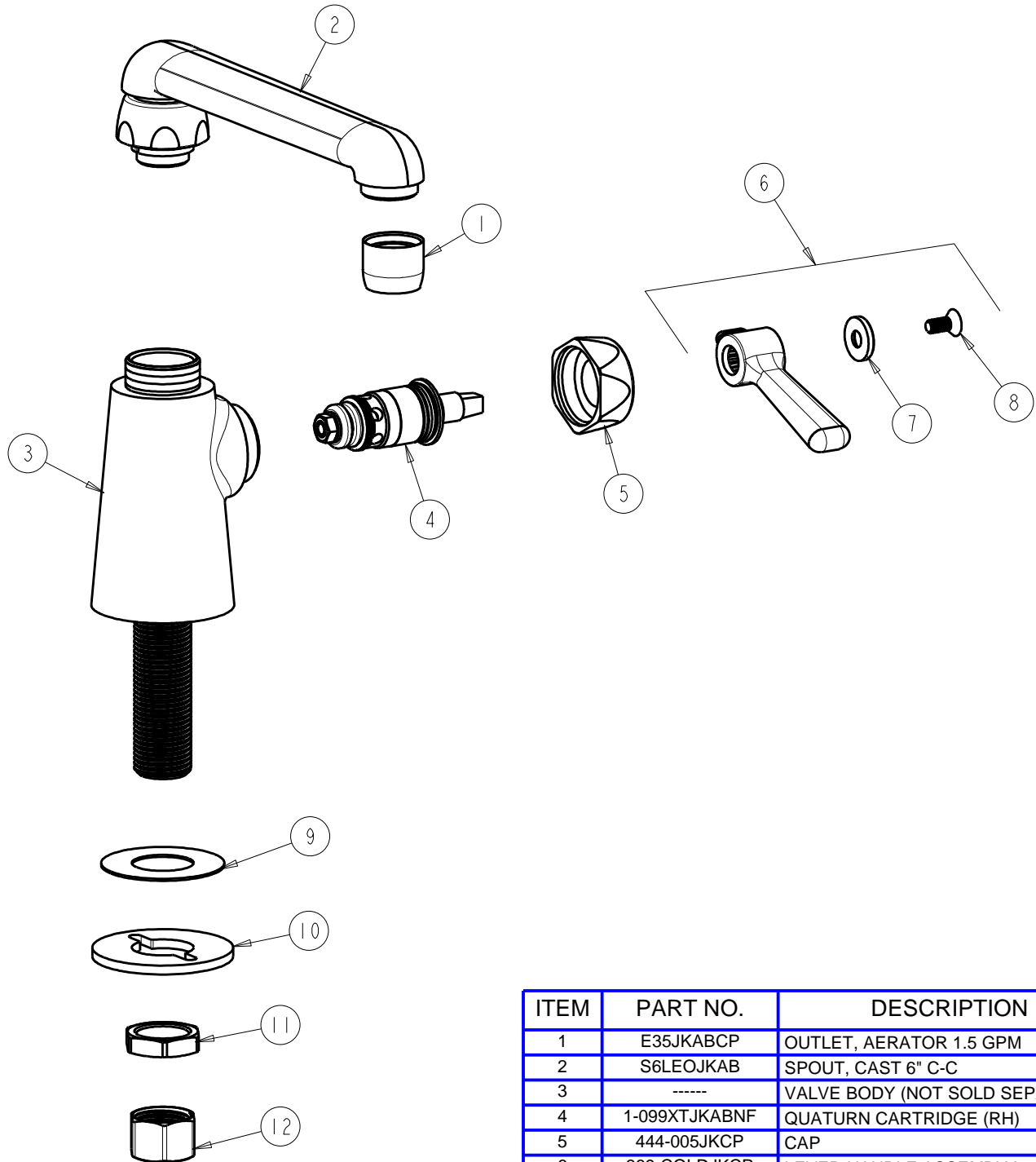

| ITEM | PART NO. | DESCRIPTION |
|------|---------------|----------------------------------|
| 1 | E35JKABCP | OUTLET, AERATOR 1.5 GPM |
| 2 | S6LEQKAB | SPOUT, CAST 6" C-C |
| 3 | ----- | VALVE BODY (NOT SOLD SEPARATELY) |
| 4 | 1-099XTJKABNF | QUATURN CARTRIDGE (RH) |
| 5 | 444-005JKCP | CAP |
| 6 | 369-COLDJKCP | LEVER HANDLE ASSEMBLY |
| 7 | 633-123JKNF | INDEX BUTTON (BLUE) |
| 8 | 420-020JKNF | SCREW, 1/8 FLAT HEX HEAD X 1/2 |
| 9 | 333-103JKNF | RUBBER WASHER |
| 10 | 807-112JKNF | WASHER |
| 11 | 49-004JKRBF | LOCKNUT |
| 12 | 49-005JKRBF | COUPLING NUT |