

Part No: CLIC2-020

**CLIC® TOP & CLIC® Pipe
Hangers & Spacers**

CLIC® Original Pipe Hangers

Desc: 2 IPS CLIC LIGHT GRAY PIPE CLAMP

MSRP: 14.01

Part Code: 893

Weight(lbs): 0.084

Weight(kg): 0.038

Weight(gm): 38

Size: 2

Color: GRAY

Material: Copolymer

Type IPS Pipe Hanger

Connection Pipe Clamp

Note Not Approved for FlameGuard®
Pipe

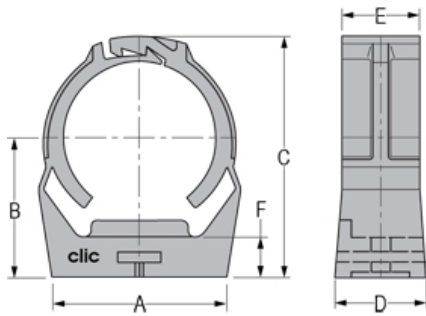

E = 27/32

F = 7/16

A = 2-5/8

B = 2-1/16

C = 3-15/32

D = 15/16

Injection Molded Dimension References:

G = (LAYING LENGTH) intersection of center lines to bottom of socket/thread; 90° elbows, tees, crosses; ± 1/32 inch.

H = Intersection of center lines to face of fitting; 90° elbows tees, crosses; ± 1/32 inch.

J = Intersection of center lines to bottom of socket/thread; 45° elbows; ± 1/32 inch

L = Overall length of fittings; ± 1/16 inch.

M = Outside diameter of socket/thread hub; ± 1/16 inch.

N = Socket bottom to socket bottom; couplings; ± 1/16 inch.

W = Height of cap; ± 1/16 inch

Typical Molded Dimension References

