

The Model V26 is an anti-siphon, vacuum breaker protected wall faucet designed for irrigation purposes in mild climate areas. The Model V26 is designed to be mounted directly to a wall or column with a top mount inlet. Designed to blend with modern architecture for installation on or in service stations, custodial services, churches, motels, restaurants, etc.

Anti-Siphon Wall Faucets Model V26



SPECIFICATIONS:

VACUUM BREAKER - ANTI-SIPHON:

- NIDEL® Model 50HF with ¾ inch male hose thread
- ASSE Standard 1052 approved 
- IAPMO® listed

EPDM PACKING: Prevents leaking.

PACKING NUT: Adjustable brass nut with deep stem guard.

VALVE SEAT: Standard "O" size washer.

HANDLES: Furnished with a polycarbonate handle and loose tee key. Or add -MH for Metal Handle no tee key.

INLET: ½ FPT.

MAX PRESSURE: 125 p.s.i.

MAX TEMPERATURE: 120° F

SHIPPING WEIGHT: (per unit): 1.4 lb

EXTERIOR FINISH: Chrome (CH) or Rough Brass (BR)



Chrome (CH)
Inlet Description
Top Inlet 1/2" FPT
Rough-In Dimensions

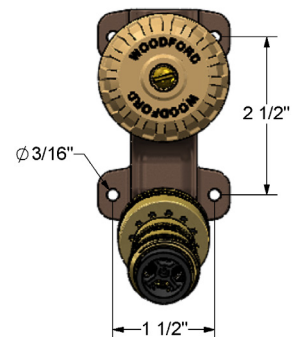
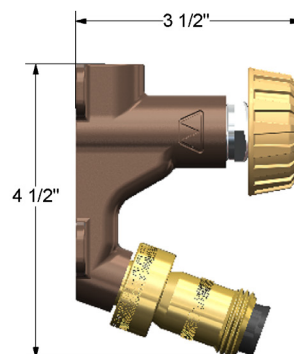
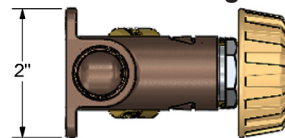

MODEL V26 PARTS LIST		
ITEM	PART#	DESCRIPTION
1	30009	Washer Screw
2	30008	Washer
3	30104	Operating Stem
4	30105	Packing Support Washer
5	30247	EPDM Packing
6	30109	Packing Nut - Chrome
	30107	Packing Nut - Brass
7	30120	Wheel Handle - Clear
	30233	Wheel Handle - Tan
8	30121	Handle Screw - Nickel
	30002	Handle Screw - Brass
9	50HF-CH	50HF Vacuum Breaker - Chrome
	50HF-BR	50HF Vacuum Breaker - Brass
	50009	Tee Key
-MH	30106	Metal Handle Chrome Option
	30239	Metal Handle Brass Option

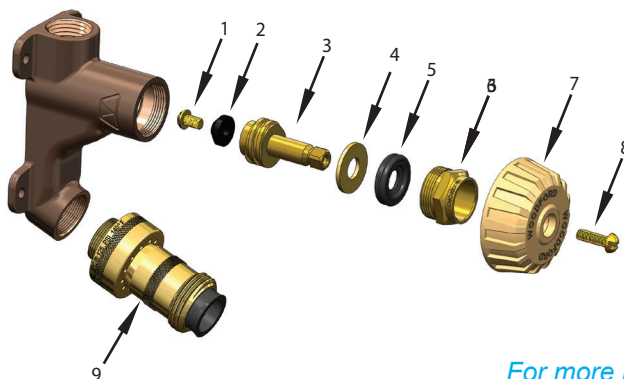

For Installation / Troubleshooting Instructions go to
<https://www.woodfordmfg.com>
Patent Information is available at:
<https://www.Woodfordmfg.com/patents/>
or call 1-800-621-6032

For more information contact...

WOODFORD MANUFACTURING COMPANY, LLC

2121 Waynoka Road, Colorado Springs, Colorado 80915 • Phone: (800) 621-6032

To view our complete product line visit: www.woodfordmfg.com/Woodford/

email: sales@woodfordmfg.com POs: PO@woodfordmfg.com