

Equa-Flo™ Valve for Column Showers

Installation and Maintenance

NOTE: Should the rotor come off the stem, align groove in outer rim of rotor with groove in spline on the stem when reassembling. Also, if you should wish to reverse hot for cold and cold for hot due to install error, or back-to-back installation, you can reassemble the rotor 180° against the stem and valve will work properly.

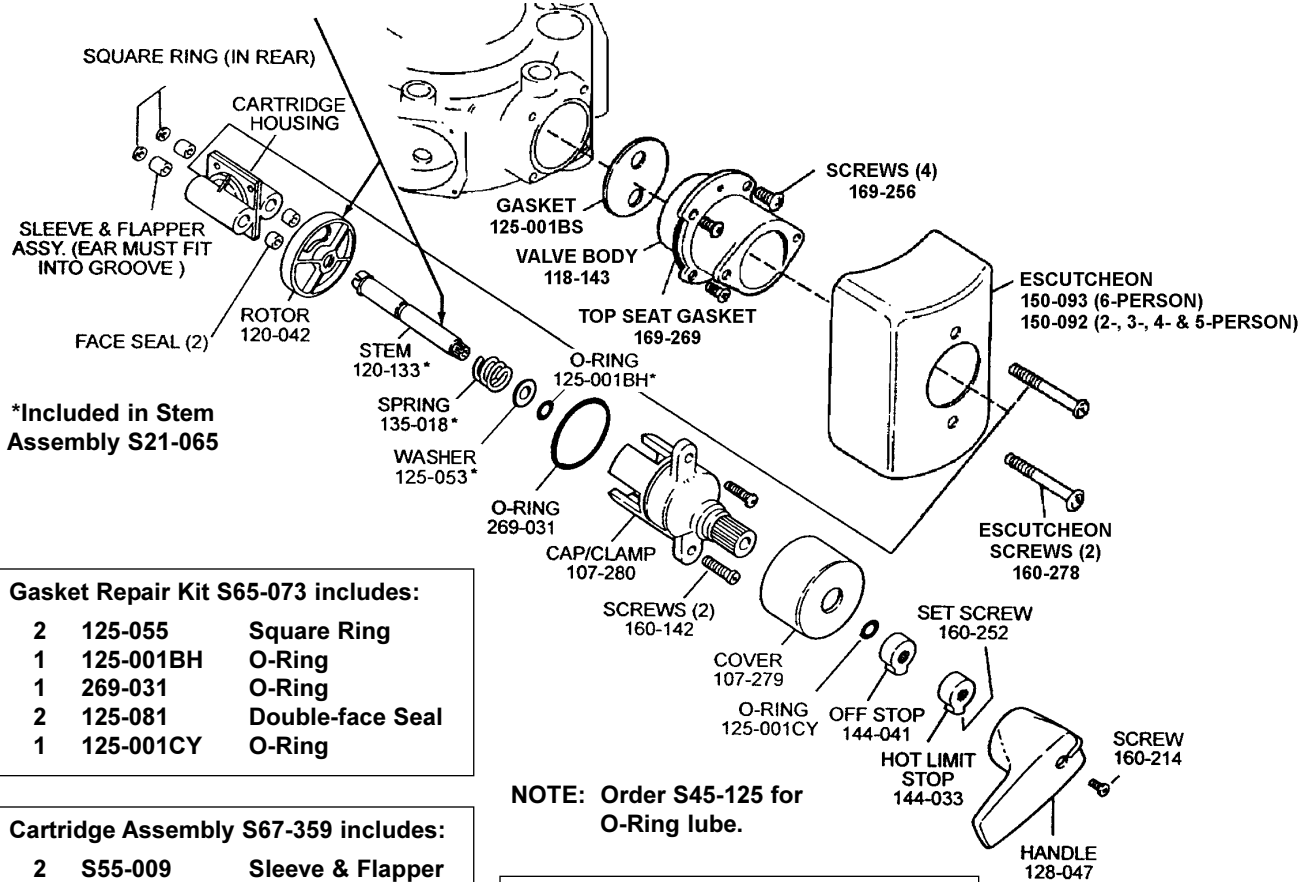

Gasket Repair Kit S65-073 includes:

- | | | |
|---|-----------|------------------|
| 2 | 125-055 | Square Ring |
| 1 | 125-001BH | O-Ring |
| 1 | 269-031 | O-Ring |
| 2 | 125-081 | Double-face Seal |
| 1 | 125-001CY | O-Ring |

Cartridge Assembly S67-359 includes:

- | | | |
|---|---------|-------------------|
| 2 | S55-009 | Sleeve & Flapper |
| 2 | 125-081 | Double-face Seal |
| 2 | 125-055 | Square Ring |
| 1 | 118-145 | Cartridge Housing |

NOTE: Order S45-125 for O-Ring lube.

Complete Column Valve Replacement:

- | | |
|---------|----------------|
| S65-075 | for 2-5 Person |
| S65-076 | for 6-person |

Valves are equipped with a temperature limit stop which can be used to limit the temperature of tempered water discharged. To adjust the temperature, remove the handle and loosen the set screw. Remove the limit stop and reposition to desired setting. Turn the limit stop clockwise for a hotter setting and counterclockwise for a cooler setting.



Position the Temperature Limit Stop As Shown

NOTE: When replacing the double face seals, lubricate the top face with a small amount of lubricant.

When assembling cap into valve body, use lubricant on 269-031 O-ring to prevent twisting of O-ring.

